

EPOS | SENNHEISER

GSX 300

External USB sound card compatible with the EPOS Gaming Suite

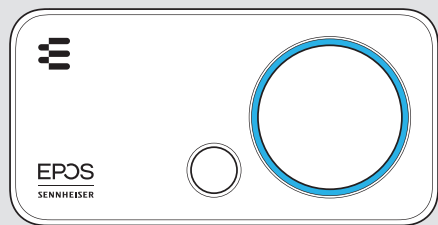

Quick Guide

Model: SCGD8

For FAQs & support:

▶ Contact our product service support:
www.eposaudio.com/support

For further information & tutorials:

▶ Visit our website:
www.eposaudio.com/gaming/downloads



Sennheiser Communications A/S

Industriparken 27, DK-2750 Ballerup, Denmark
www.eposaudio.com

Printed in China, Publ. 07/20, 770-00240/A02

1 Package contents

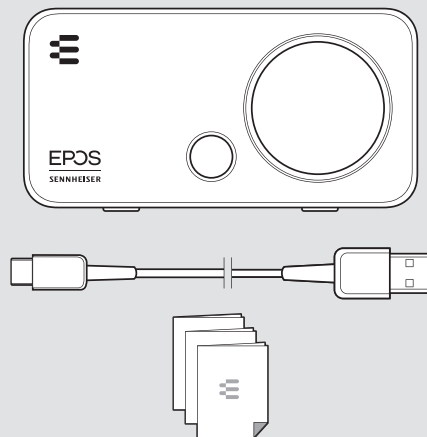

2 Connecting the headset

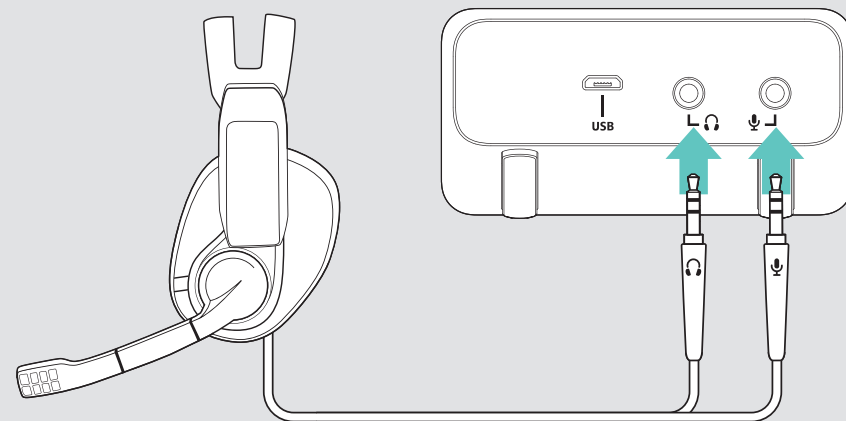

3 Connecting the GSX 300 to a PC

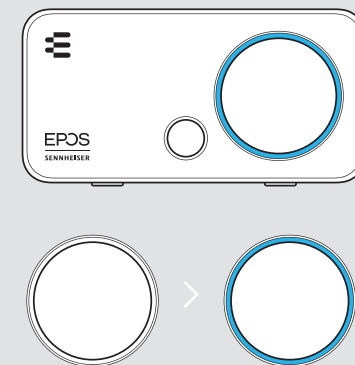
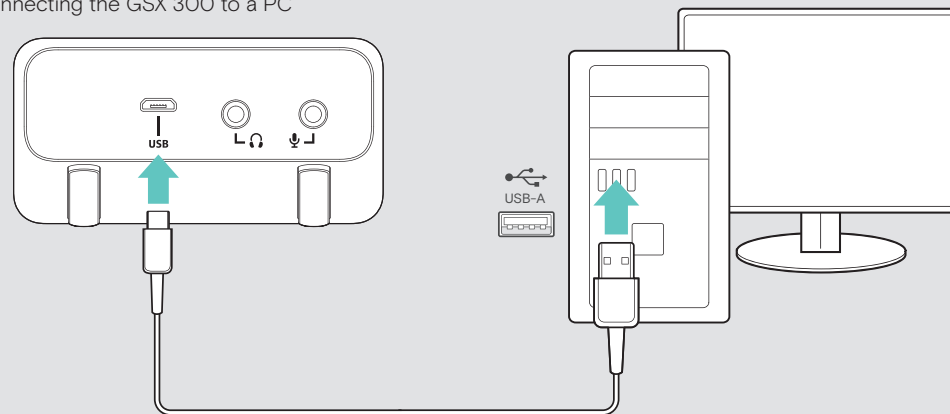

4 Installing the Gaming Suite on a PC



5 Manual download

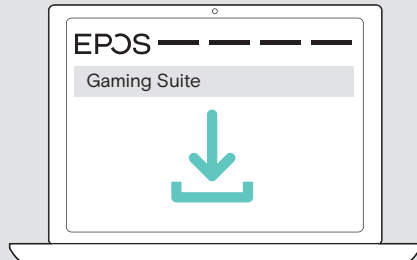

www.eposaudio.com/gaming/downloads



6 Smart Button: Switching between 2.0 stereo & 7.1 surround sound



A 2.0

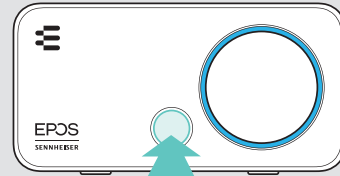

B 7.1



7 Smart Button: Switching between Presets

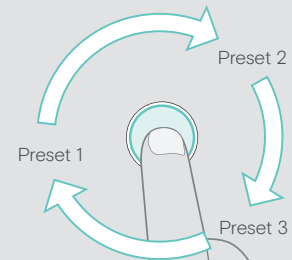
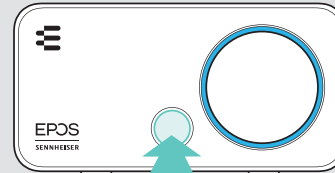
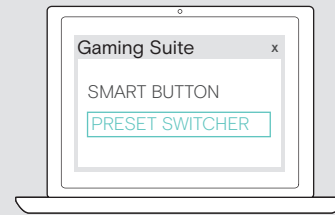

8 Adjusting the volume

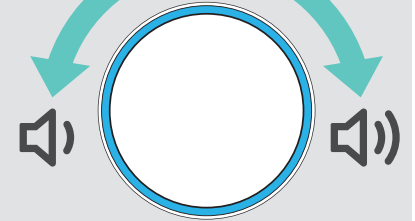
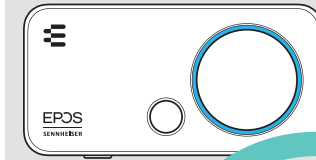

9 Cleaning the product

