

EPDS

# EXPAND Control

The EXPAND Control is a purpose-built tablet that serves as either a meeting room controller or a scheduling panel, seamlessly integrating with leading UC solutions for any meeting room. Hassle-free installation and flexible tidy mounting options deliver an intuitive user experience that drives fast deployment and adoption.



red dot winner 2023



# Key Features

## Enhanced meeting control

The tablet serves as either a meeting room touch controller or scheduling panel which seamlessly integrates with leading UC-solutions, providing a superior meeting experience

## Superior user-experience

Designed for an outstanding and ergonomic user experience, the tablet has an optimal viewing angle and a large 10.1" anti-glare treated touch screen

## Adapts to all meeting spaces

Suitable for any meeting room size or type, it also supports EPOS EXPAND Vision video conferencing solutions



## Flexible and tidy setup

Multiple mounting options, integrated cable retention and a single Power over Ethernet cable ensure an optimal and clean installation

## Certified solution

Certified for leading UC solutions including Microsoft Teams Rooms on Android™ and Zoom Rooms, it delivers a flawless user experience and comes with a trusted stamp of approval

# What's in the Box



EXPAND Control



Tabletop mount

Quick Guide

Compliance Sheet

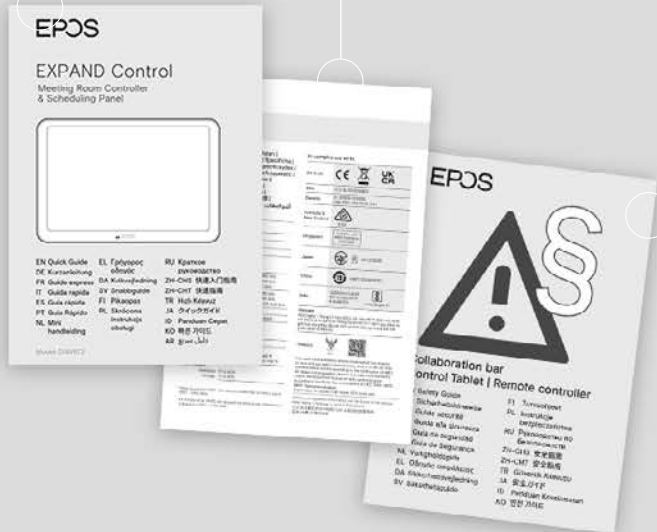

Safety guide

Power over Ethernet (PoE) cable

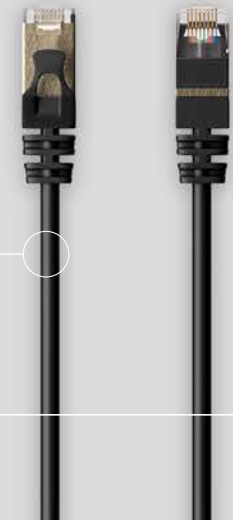

---

# Additional benefits & features



## Secure mounting options

Optional wall and table mounting alternatives allows for flexible placement, Kensington lock support for secure installation



## Centralized device management

Remote device administration through EPOS Manager or UC provider solutions



## Room bookings, simplified

Side LED-lights clearly indicate room availability – even from a distance



## Automatic power saving

Goes into power saving mode when the motion sensor detects no activity in the meeting room



## Warranty and support

A two-year warranty ensures your investment is protected. Access to the EPOS Support team for questions and assistance is included

---

---

# Product data

1/4

## General

Color	Black
Weight	1230 g / 43.38 oz
Dimensions	167 x 247 x 104 mm / 6,6 x 9,7 x 4,1 in (H x L x W)
Warranty	2 years. Extended warranty available for purchase

## Technical

Operating system	Android™ 10 (or later)
Internal storage	16 GB
CPU	Arm® v8 64-bit 6-core
GPU	Quad Core Arm®
Chipset	Rockchip
RAM memory	4 GB
Supply voltage	36-57V (PoE)
Power consumption	15 W

# Product data

2/4

## Network & Connectivity

Power over Ethernet (PoE)

IEEE 802.3 af Class 3

Ethernet

IPv4 &amp; IPv6, DHCP / Static IP

Wi-Fi

Dual-band: (2.4 / 5 GHz)  
Standard: 802.11ac / 802.11ac

Bluetooth®

Version 5.0  
Bluetooth® profiles: A2DP, HSP, AVRCP  
Microsoft Teams proximity join

## Privacy/Security

Security lock support

Kensington™

Encryption

Hardware encryption (up to 512 bits);  
AES encryption (256 bits);  
SHA encryption (256 bits);  
SecureBoot; SSL traffic encryption

## Usability

Display

10.1" LCD touch screen to access call controls and settings

Resolution

1280 x 800

Viewing angle

85, 85, 85, 85 degrees (U / D / L / R)

Positioning/placing angle

36 degrees

---

# Product data

3/4

## Products variants

---

EXPAND Control

---

EXPAND Vision 5 Bundle

---

EXPAND Vision 3T Bundle

---

## Software

---

EPOS devices can be managed with following Software solutions:

---

EPOS Manager

---

## What's in the box

---

EPOS EXPAND Control, Power over Ethernet (PoE) cable, Tabletop bottom plate, Safety guide, Quick guide and Compliance sheet

---

**EXPAND Control:** EPOS EXPAND Control, Power over Ethernet (PoE) cable, Tabletop bottom plate, Safety guide, Quick guide and Compliance sheet.

**EXPAND Vision 5:** EPOS EXPAND Vision 5 video bar, Universal power supply, HDMI cable, Wall mount bracket, Safety guide, Quick guide and Compliance sheet

---

**EXPAND Control:** EPOS EXPAND Control, Power over Ethernet (PoE) cable, Tabletop bottom plate, Safety guide, Quick guide and Compliance sheet.

**EXPAND Vision 3T Core:** EPOS EXPAND Vision 3T video bar, Bluetooth® remote control, Universal power supply, USB-C extension cable (5 m/16 ft), HDMI cable, USB-C to USB-A adapter, Wall mount bracket, Safety guide, Quick guide and Compliance sheet.

**EXPAND 80T:** EXPAND 80T Bluetooth® speakerphone, USB-C cable, BTD 800 USB dongle, Power supply unit (universal), USB-C to USB-A adapter, Safety guide, Quick guide, Compliance sheet

---

Manage, update and configure EPOS audio and video devices from any location.

For both cloud and on-premises solutions: [eposaudio.com/software-epos-manager](https://eposaudio.com/software-epos-manager)

---

---

# Product data

4/4

Product	Certifications	EAN code	UPC code
EXPAND Control Art. no. 1001072	Certified for leading UC solutions incl. Microsoft Teams Rooms on Android™ and Zoom Rooms	57 14708 00874 3	8 40064 40874 5
EXPAND Vision 5 Bundle Art. no. 1001181	Certified for leading UC solutions incl. Microsoft Teams Rooms on Android™ and Zoom Rooms	57 14708 00985 6	8 40064 40985 8
EXPAND Vision 3T Bundle Art. no. 1001182	Certified for Microsoft Teams Rooms on Android™	57 14708 00986 3	8 40064 40986 5



---

# Spare parts

1/1

Product	Art. no.	Description	EAN code	UPC code
Control - TTM 01	1001155	Tabletop fixture to secure optimal positioning of the EXPAND Control	57 1470800957 3	8 4006440957 5

# Accessories

1/1

Product	Price	Art. no.	Description	EAN code	UPC code
Control - WM 01	MSRP: €50 / \$55	1001090	Wall mount for EXPAND Control	57 14708 00892 7	8 40064 40892 9
Control - DM 01	MSRP: €55 / \$60	1001091	Desk mount for EXPAND Control	57 14708 00893 4	8 40064 40893 6
Control WM - G	MSRP: €80 / \$90	1001249	EXPAND Control wall mount for walls where drilling is not possible	57 1470801056 2	8 4006441056 4



Control - WM 01



Control - DM 01



Control WM - G

---

# Appendix

1/1

## Additional product data

USB output	5 V, 500 mA
Operating temperature (Max)	65 °C / 149 °F
Operating temperature (Min)	-20 °C / -4 °F
Operating humidity (Max)	90%
Storage temperature (Min)	-40 °C / -40 °F
Storage temperature (Max)	70 °C / 158 °F
Usability	Capacitive touch sensor supports touch functionality
Side-LED	Multi-colored LED indicators
Mounting Options	Designed with integrated table stand (other mounting options available)